

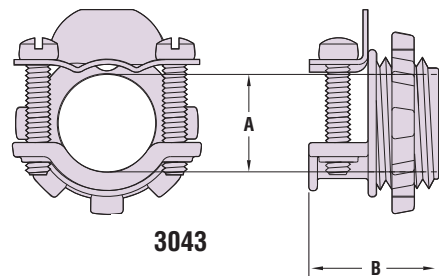

Heyco® Zinc Die-Cast Box Connectors

TRADE SIZE	NOMINAL MOUNTING HOLE DIAMETER		WILL FIT THESE CABLES* Flexible Metallic Conduit	Non-Metallic Sheathed		PART NO.	DESCRIPTION	PART DIMENSIONS					
	in.	mm.		Armored ***	Non-Metallic Sheathed			A		B		Overall Length	
								Minimum Wire in.	Maximum Wire mm.	in.	mm.	in.	mm.
Clamp-Type Connector													
3/8**	.875	22,2	-	14/2, 14/3, 12/2, 12/3, 10/2, 10/3	14/2, 12/2, 12/3	3043	751 aka Romex® Connector	.18	4,6	.64	16,3	.81	20,6
90° Angle Connectors													
3/8**	.875	22,2	3/8	14/2, 14/3, 14/4, 12/2, 12/3, 12/4, 10/2, 8/1, 6/1, 4/1	-	3030	561	.45	11,4	.63	16,0	1.81	46,0
1/2	.875	22,2	1/2	8/2	-	3031	563	.65	16,5	.97	24,6	2.05	52,1
Combination Connectors													
3/8**	.875	22,2	3/8	14/2, 14/3, 14/4, 12/2, 12/3, 12/4	14/2, 14/3, 12/2, 12/3	3029	551	.35	9,0	.43	11,0	.79	20,0
						3040	551 No Nut						
Box Connector													
1/2	.875	22,2	n/a	n/a	n/a	9840	SP1	.40	10,2	1.12	28,4	.31	7,9

*Gauge/Conductors, except FMC.
 **1/2" K.O.
 ***Not UL Rated for armored cable.



3043

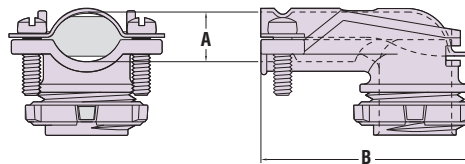

3030/3031

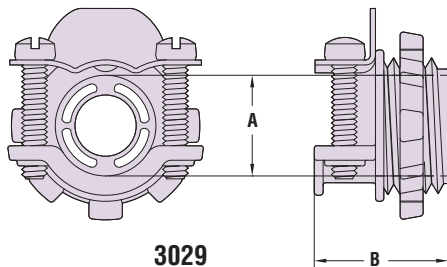

3029

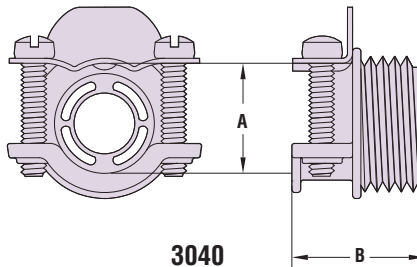

3040

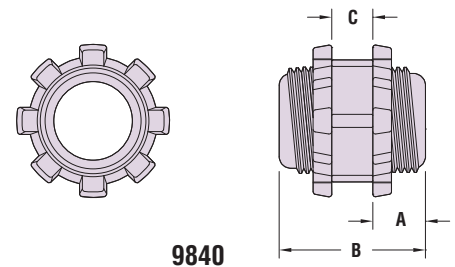

9840

Material: Zamak 3
 Certifications: Listed under Underwriters' Laboratories File E103541
 Certified by the Canadian Standards Association File 88539



3043

Part No. 3043 (751) commonly known as a Romex® Connector.
 • Also fits corrugated MC at .51" (13,0 mm) diameter, smooth MC at .35" (8,8 mm) to .53" (13,3 mm) diameter.
 • DFARS Compliant



9840

• Provides a connecting link between boxes, panels or chassis.
 • Space boxes 5/16" (7,9 mm) apart.
 • Die-cast locknut included.
 • DFARS Compliant

Quick Specs